

We provide your solutions

CDG-SL, CDG-S, CDG-L Dial Gear Type Level Transmitter



CDG SERIES



VARIOUS LEVEL SENSORS & CONTROLLERS FOR YOUR APPLICATIONS



CDI TECH CO.,LTD.

Suite 706 WorldMeridian Venture Center II, 426-5, Kasan-Dong, Kumchun-Gu, Seoul, Korea
Phone : 82-2-2025-8188 FAX: 82-2-2025-8187 e-mail: cdi@cdinstech.com
Web : www.cdikorea.com

We provide your solutions

CDG-SL, CDG-S, CDG-L Dial Gear Type Level Transmitter

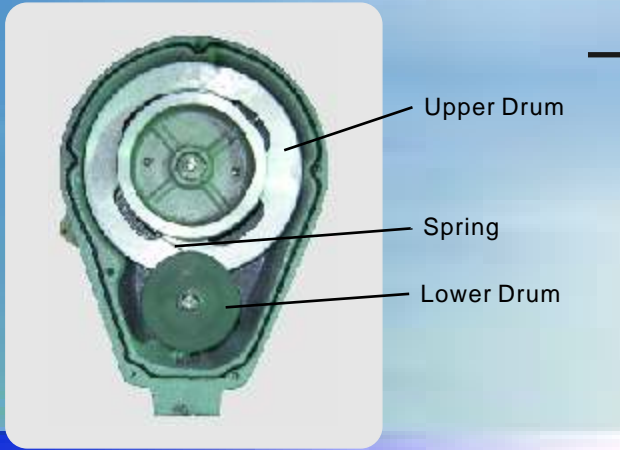

OPERATING PRINCIPLE

The buoyancy from stainless steel float ball on the surface of the liquid transmitted to the torque spring in the housing by stainless steel wire and the spring adjust counter balance until equal to the buoyancy. The internal gear in the housing which is connected to that spring rotate to fasten or loosen the wire and indicator display proportional to the liquid level.

There are three types of dial gear type level transmitters. Only local indicating dial gauge type, Internal gear rotation electrically connected potentiometer and converter to transmit 4-20mA DC current to the control unit or digital indicator to monitoring and controlling the level in the central room, and both local indication and current transmitting converter in one unit type.



FEATURE & BENEFIT

FEATURE

- Only local indicating or only signal output or local indication and signal output version available
- 2-wire loop power (DC24V & DC4-20mA)
- Weather-proof enclosure Ip65
- 2" screw or various sizes of flange mounting
- Rugged aluminum die casting housing & SUS float
- With various level controllers, various contact mode available

BENEFIT

- Mechanically simple structure enable easy maintenance.
- Ideal to mount where is no room between top of tank and ceiling
- Maximum measuring range is up to 12m
- In case of local indicating version, no need main power, electrically free.
- Rugged die-cast aluminum designed ensure long life time
- Remote control at the local or central panel

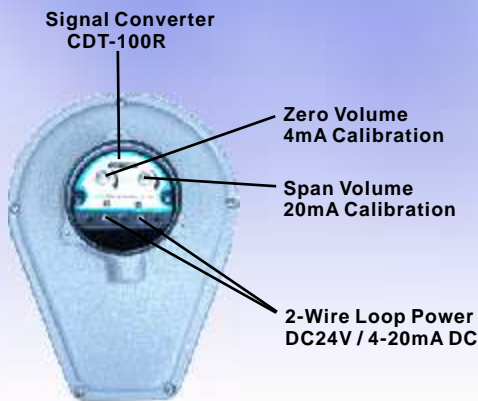

We provide your solutions

CDG-SL, CDG-S, CDG-L Dial Gear Type Level Transmitter



TECHNICAL SPECIFICATIONS

Operating condition

Measured Object
Liquid Temperature
Operating Pressure
Ambient Temperature
Measuring Range
Density
Viscosity
Measuring Accuracy
Measuring Option

Liquid
-20°C to +80°C
Less than 10bar
-20°C to +60°C
6m (Std.), Option: 12m
More than 0.4 kg/l
Max. 600cP
±0.5% of F.S.
Guide chamber

Connection

Screw connection
Flange connection

2" Screw (on request)
JIS 10K 80A 6T
JIS 10K 100A 6T
JIS 10K 125A 6T
Option : request size & ratings

Materials

Housing(Head)
Indicating Window
Flange
Wire
Float
Connect ring
Converter Box
(Terminal Box)

Cast aluminium
Glass fiber
Stainless Steel 304
Stainless Steel 304
Stainless Steel 304
Stainless Steel 304
Cast aluminium

Enclosure & Signals

Head
Float
Cable
Glands
Power Source
Output Signal

IP65 (NEMA4X)
IP68
2-shield wire CVV-SB
PF 1/2"
DC24V
DC 4-20mA

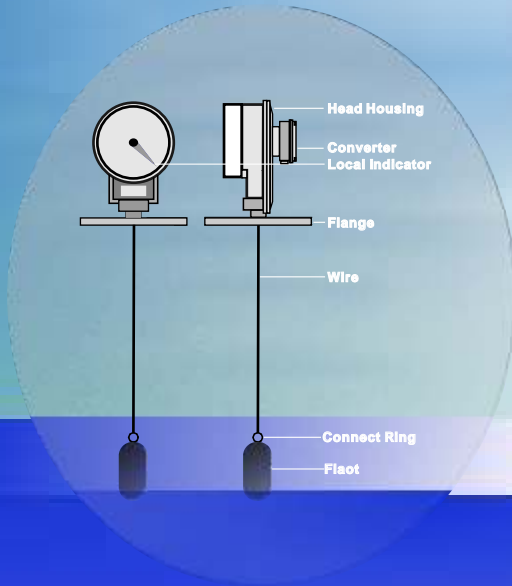

APPLICATIONS

Water and aqueous liquids
Chemicals
Oil
Storage tank
Acids
Alkalis
Organic and inorganic solvents



We provide your solutions

CDG-SL, CDG-S, CDG-L Dial Gear Type Level Transmitter



DIMENSIONS

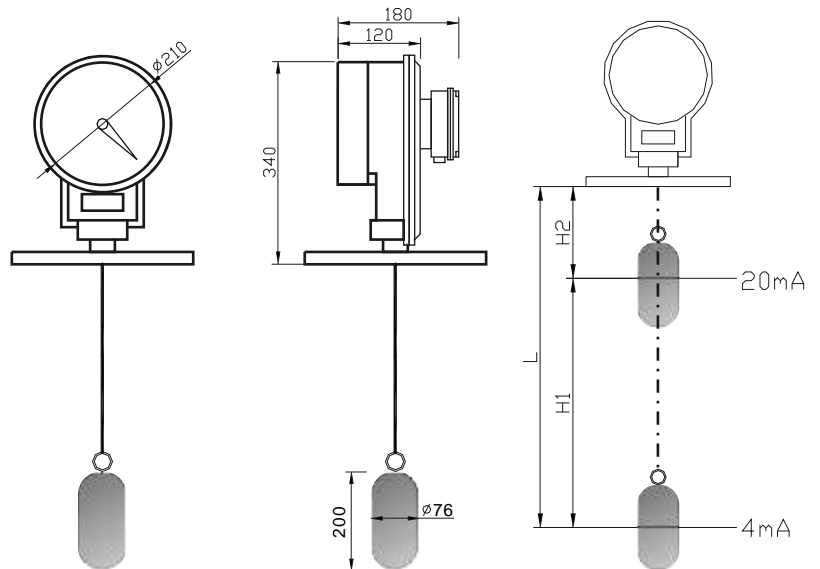

ORDERING CODE

Dial Gear Type Level Meter Model CDG Series

Type	CDG-
Only Local Indicator	L
Blind & Only Current Signal Output	S
Local Indicator & Currnt Signal Output	SL
Connection (Flange or Screw Size)	
JIS 10K 80A (6t)	F3
JIS 10K 100A (6t)	F4
JIS 10K 125A (6t)	F5
2" Screw	S2
Measuring Information (refer to above drawing)	
0-100% Measuring Range in (mm)	H1 (mm)
Dead Zone in (mm)	H2 (mm)
Ordering Code Example	CDG- SL- F4- 5000 - 300